



# AERE 2017 Pittsburgh

ASSOCIATION OF ENVIRONMENTAL AND RESOURCE ECONOMISTS  
6<sup>TH</sup> ANNUAL SUMMER CONFERENCE  
MAY 31 – JUNE 2, 2017  
OMNI WILLIAM PENN HOTEL  
PITTSBURGH, PENNSYLVANIA

AERE Annual Summer Conferences  
Excellence in Academic Programming – Collegiality in Destinations Worth Visiting



## AERE Officers

President: Laura O. Taylor,  
North Carolina State University  
Vice President: Andrew Plantinga,  
University of California, Santa Barbara  
Secretary: Sarah West,  
Macalester College  
Treasurer: Dallas Burtraw,  
Resources for the Future  
Past-President: W.L. (Vic) Adamowicz,  
University of Alberta

## AERE Board of Directors

Severin Borenstein, University of California, Berkeley  
Karen Fisher-Vanden, Pennsylvania State University  
Meredith Fowlie, University of California, Berkeley  
Elena G. Irwin, The Ohio State University  
Billy Pizer, Duke University  
Ann Wolverton, Environmental Protection Agency

### Ex-Officio Board Members:

Carlo Carraro, Università Ca' Foscari Venezia  
Don Fullerton, University of Illinois  
Marilyn Voigt, AERE Executive Director

## AERE Summer Conference 2017 Organizing Committee

Karen Clay, Carnegie Mellon University, Co-Chair  
Randy Walsh, University of Pittsburgh, Co-Chair  
Edson Severnini, Carnegie Mellon University  
Jeremy Weber, University of Pittsburgh

## 2017 Institutional Members

The Brattle Group  
Environmental Defense Fund  
Fondazione Eni Enrico Mattei (FEEM)  
Resources for the Future  
US Forest Service, Rocky Mountain Research  
Station  
W.H. Desvousges & Associates, Inc.

## 2017 University Members

Appalachian State University, Department of  
Economics  
Clark University, Economics Department  
Colorado School of Mines, Division of Economics  
and Business  
Colorado State University, Department of  
Agricultural and Resource Economics  
Columbia University, School of International and  
Public Affairs and The Earth Institute  
Duke University, Energy Initiative  
Harvard University, Harvard Environmental  
Economics Program  
Iowa State University, Agricultural and Rural  
Development  
Johns Hopkins University, Carey Business School  
& Whiting School of Engineering  
Mississippi State University, Department of  
Agricultural Economics  
North Carolina State University, Department of  
Agricultural and Resource Economics  
Texas A&M University  
University of California - San Diego, Department  
of Economics  
University of Chicago  
University of Connecticut, Department of  
Agricultural and Resource Economics  
University of Gothenburg, Department of  
Economics  
University of Hawaii at Manoa, Department of  
Economics  
University of Illinois at Urbana - Champaign,  
Agricultural & Consumer Economics  
University of Oregon  
University of Tennessee, Department of  
Economics  
Virginia Tech, Agricultural & Applied Economics

**AERE GRATEFULLY ACKNOWLEDGES  
THE FINANCIAL SUPPORT PROVIDE BY:**

***Legacy Sponsors***

---



***Gold Sponsors***

---



University of  
Pittsburgh

---

Department of Economics

## *Silver Sponsors*

---

**Carnegie Mellon University**  
**HeinzCollege**  
INFORMATION SYSTEMS • PUBLIC POLICY • MANAGEMENT

**Carnegie Mellon University**  
Scott Institute  
for Energy Innovation

## *Bronze Sponsors*

---

**GSPIA**  
University of Pittsburgh  
Graduate School of Public  
and International Affairs

**IEC**

INDUSTRIAL ECONOMICS, INCORPORATED



**RESOURCES  
FOR THE FUTURE**

## *Other Contributors*

---

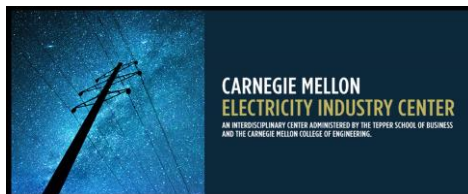

AERE is grateful to following funders for making this year's sponsored sessions possible:

National Oceanic and Atmospheric Administration

U.S. Department of Commerce

Economic Research Service

U.S. Department of Agriculture

Microsoft Corporation

AERE Summer Conference App: To access the full program, please download the AERE 2017 Summer Conference App by following this link (<https://attendify.com/app/ty7cq7/>) or by searching "AERE Summer Conference 2017" in your app store.

Information on General Sessions: All sessions are 90 minutes each. General Sessions typically include four papers. Each presenter will have 15-18 minutes, followed by 2-4 minutes of audience questions and feedback. No General Session presentation (including questions) can exceed 22 minutes – this will be strictly enforced by the session chair. Sessions with fewer than 4 papers must also follow this format – a maximum of 22 minutes per paper. This will allow audience members to move between sessions after one paper is completed and can see another paper start at about the same time in another session. To further enable this movement between sessions, papers should be presented in the order they appear in the program.

Information on Sponsored Sessions: Sponsored Sessions are 90 minutes each. Sponsored Sessions consist of three papers, each with 15 minutes for presentation, 8 minutes for a discussant, and 7 minutes for audience questions. No Sponsored Session presentation (including discussant and questions) can exceed 30 minutes – this will be strictly enforced by the session chair.

AERE Press Policy: Members of the press are welcome to register for the conference—credentials should be presented at Registration. Press are expected to follow rules of academic conference decorum. Q&A periods follow paper presentations in each session and time limits are managed by the assigned Session Chair.

Transportation: The cheapest way to get from the airport to Omni Penn William Hotel will be to take the 28X Airport Flyer public bus. The pick-up location is outside Door 6 of the baggage claim area and the closest stop to the hotel is at the corner of Seventh Ave at William Penn Pl. which is a 5-minute to the hotel. The bus leaves approximately every 30 minutes. The one-way trip will cost \$2.75 and must be paid in cash at the fare box at the front of the bus. Note that no change will be given. More information about the Airport Flyer can be found at the Pittsburgh Port Authority website (<http://www.portauthority.org/paac/SchedulesMaps/AirportService.aspx>). Ubers, Lyfts, and taxis are also available at the airport.

## SCHEDULE AT A GLANCE

<b>Wednesday, May 31, 2017</b>		
7:00-8:00am	Workshop Registration and Continental Breakfast	Three Rivers Foyer
8:00-5:00pm	Pre-Conference Workshop	Three Rivers
11:00-2:00pm	Conference Registration	Three Rivers Foyer
5:30-7:30pm	Conference Registration	Urban Foyer
6:00-8:00pm	Welcome Reception	Urban Room
<b>Thursday, June 1, 2017</b>		
8:00-9:00am	Conference Registration and Continental Breakfast	William Penn Ballroom
9:00-10:30am	Parallel Papers Session 1	
10:30-11:00am	Poster Session and Coffee Break	William Penn Ballroom
11:00-12:30pm	Parallel Papers Session 2	
12:30-12:45pm	Break	Grand Ballroom
12:45-2:00pm	Lunch and AERE Awards	Grand Ballroom
2:00-2:45pm	Keynote Address: Janet Currie	Grand Ballroom
2:45-3:00pm	Coffee Break	Grand Ballroom
3:00-4:30pm	Parallel Papers Session 3	
5:00-6:30pm	Wine and Beer Cash Bar Meet-up	William Penn Ballroom
6:30-9:30pm	AERE Board Meeting (Invitation Only)	Sternwheeler
<b>Friday, June 2, 2017</b>		
7:30-8:30am	Conference Registration and Continental Breakfast	William Penn Ballroom
8:30-10:00am	Parallel Papers Session 4	
10:00-10:30am	Poster Session and Coffee Break	William Penn Ballroom
10:30-12:00pm	Parallel Papers Session 5	
12:00-1:30pm	Lunch	On your own
1:30-3:00pm	Parallel Papers Session 6	
3:00-3:15pm	Coffee Break	William Penn Ballroom
3:15-4:45pm	Parallel Session 7	

Thursday Parallel Sessions										
	Breakout 1	Breakout 2	Breakout 3	Breakout 4	Breakout 5	Breakout 6	Breakout 7	Breakout 8	Breakout 9	Breakout 10
Location	Three Rivers	Riverboat	Sternwheeler	Conference A	Conference B	Conference C	Frick	Phipps	Oliver	Carnegie 3
Parallel Session 1	Sponsored Session - Shale Oil and Gas I	Pollution Control: Tradable Permits I	Sustainability, Renewables, and the Grid II	Pollution Control: Taxes	Environmental Valuation: Stated Preferences	Environment and Public Health	Resource and Ecosystem Studies: Water Management I	The Behavioral Microeconomics of Energy and Water Use	Resources and Ecosystem Studies: Biodiversity and Climate Change	Resources and ecosystem studies: Energy
Parallel Session 2	Sponsored Session - Emerging Data Opportunities I	Pollution Control: Tradable Permits II	Sustainability, Renewables, and the Grid III	Panel 1 – Assessing Approaches to Updating the Social Cost of Carbon	Environmental Valuation: Other Valuations Techniques	Resource and Ecosystem Studies: Fisheries I	Resource and Ecosystem Studies: Water Management II	Resources and Ecosystem Studies: Forest Resources I	Resources and Ecosystem Studies: Climate Change I	Applications to Environmental and Resource Economics: Field Experiments I
Parallel Session 3	JAERE Editors' Session	Emerging Data Opportunities III	Shale Oil and Gas III	Pollution Control: Voluntary Mechanisms	TBA	Resource and Ecosystem Studies: Fisheries II	Empirical Issues in Transport Economics	Resources and Ecosystem Studies: Forest Resources II	Resources and Ecosystem Studies: Climate Change II	International Environmental Issues: Development I

Friday Parallel Sessions										
	Breakout 1	Breakout 2	Breakout 3	Breakout 4	Breakout 5	Breakout 6	Breakout 7	Breakout 8	Breakout 9	Breakout 10
Location	Three Rivers	Riverboat	Sternwheeler	Conference A	Conference B	Conference C	Frick	Phipps	Oliver	Carnegie 3
Parallel Session 4	Sponsored Session - Shale Oil and Gas II	Emerging Data Opportunities IV	Environmental Valuation: Revealed Preferences I	Panel 2 – Contemporary Standards for Stated Preference Valuation	Environmental Pollution: Air Pollution	Resources and Ecosystem Studies: Energy I	Growth and Environment: Technological Change I	Extensions of Standard Theory I	Resources and Ecosystem Studies: Transport	International Environmental Issues: Development II
Parallel Session 5	Sponsored Session – Emerging Data Opportunities II	Pollution Control: Other Instruments I	Environmental Valuation: Revealed Preferences II	Pollution Control: Employment Effects	Environmental Pollution: Air and Water Pollution	Resources and Ecosystem Studies: Energy II	Growth and Environment: Technological Change II	Extensions of Standard Theory II	Agriculture: Agri-Environmental Policy and Climate Change	Applications to Environmental and Resource Economics: Field Experiments II
Parallel Session 6	Sponsored Session - Sustainability, Renewables, and the Grid I	Emerging Data Opportunities and Big Data	Environmental Valuation: Revealed Preferences III	Resources and Ecosystem Studies: Renewable Resources	Environmental Pollution: Health Implications	Resources and Ecosystem Studies: Energy III	Growth, the Environment, and International Issues	Behavioral Economics in Agri-Environmental Policy	Agriculture: Agri-Environmental Policy	Pollution Control: Other Instruments II
Parallel Session 7	JAERE Editors' Session	Pollution Control: Other Instruments	Environmental Valuation: Revealed Preferences IV	Resources and Ecosystem Studies: Non-Renewable Resources	Environmental Pollution: Avoidance Behavior and Mitigation	Resources and Ecosystem Studies: Energy IV	Resources and Ecosystem Studies: Natural Disasters	Prices, Inattention, and Information in Water Demand	Environment and the Firm	Applications to Environmental and Resource Economics: Spatial Analysis



# HOTEL LAYOUT

*William Penn - William Penn Level*

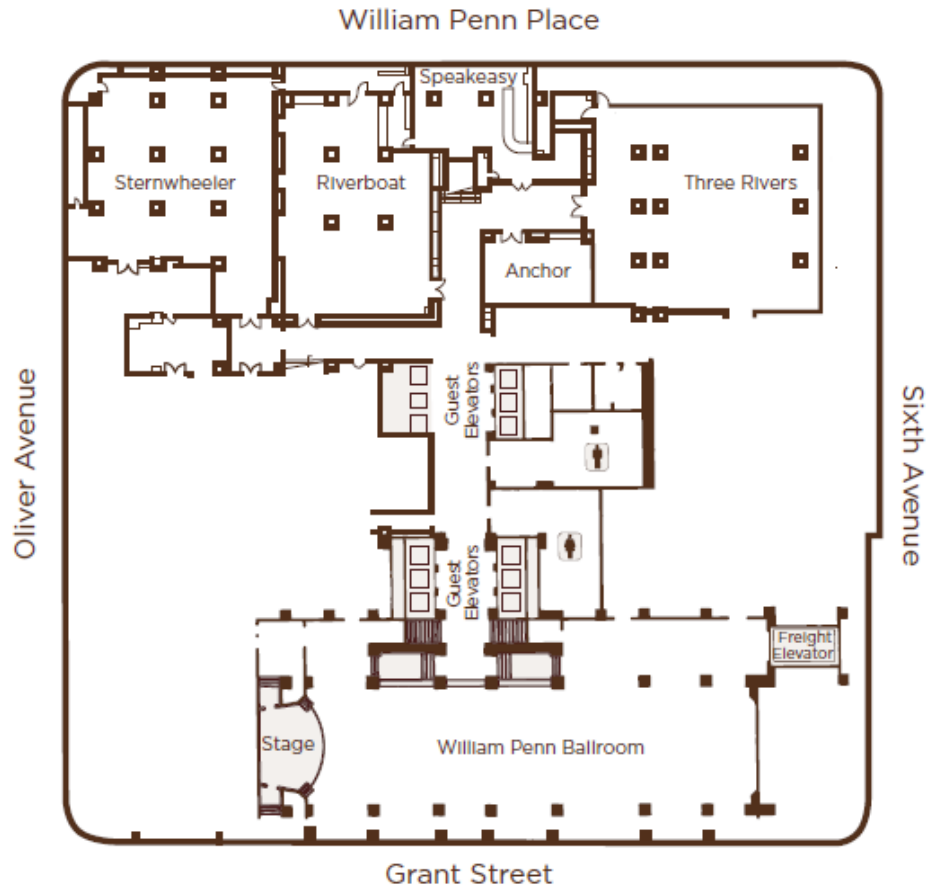

*William Penn - Mezzanine Level*

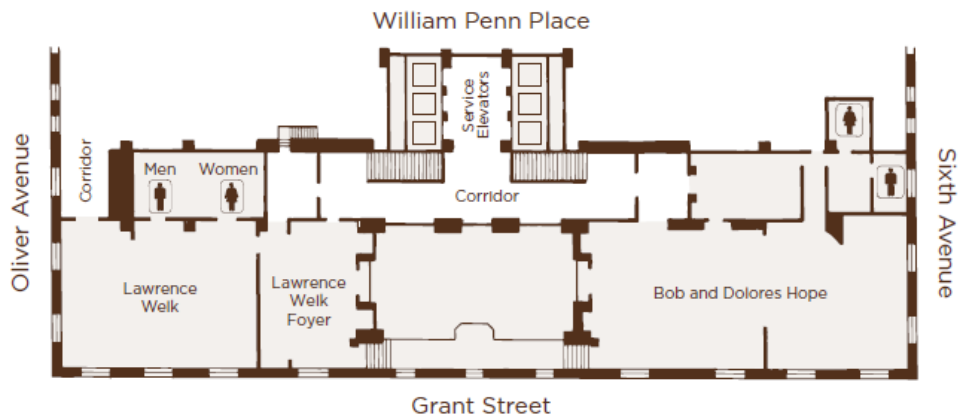

*William Penn - Conference Level*



*William Penn - First Level*

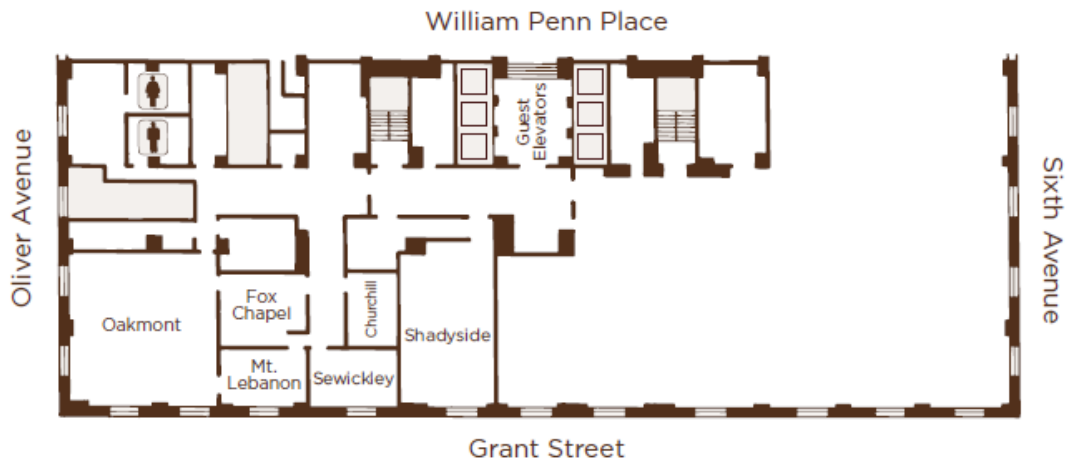

*William Penn - Seventeenth Level*

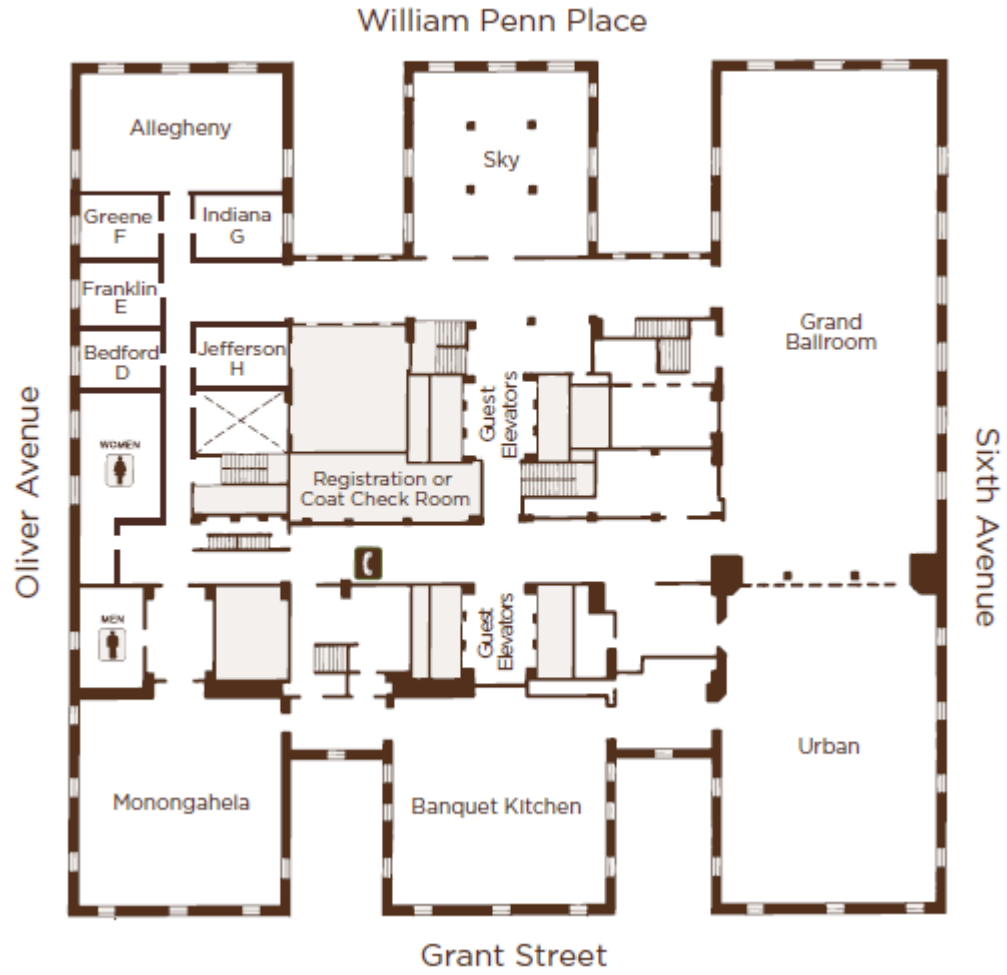

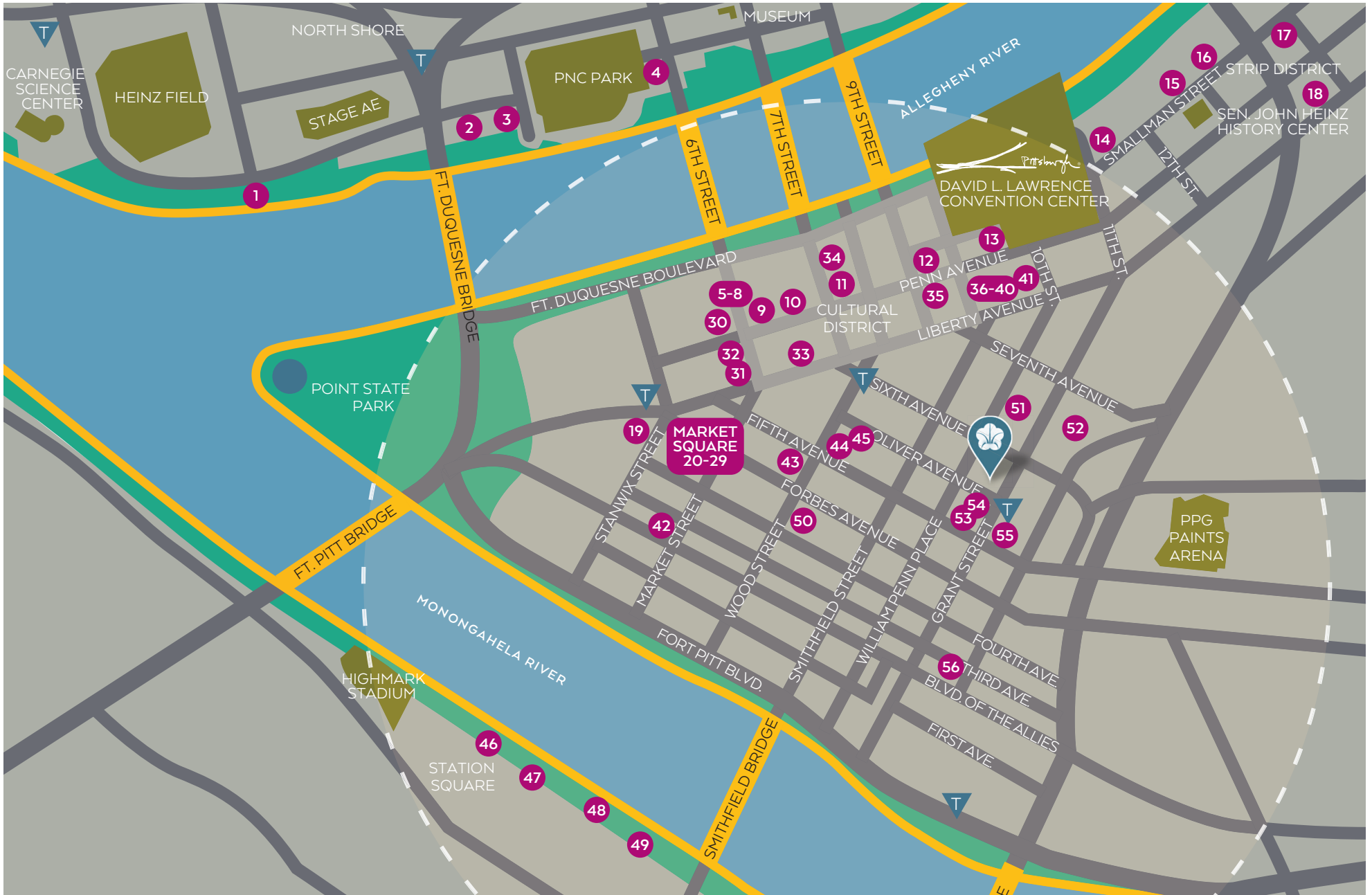

OMNI  HOTELS & RESORTS  
 william penn | pittsburgh

530 WILLIAM PENN PLACE, PITTSBURGH, PENNSYLVANIA 15219 • 412-281-7100 • [OmniHotels.com/Pittsburgh](http://OmniHotels.com/Pittsburgh)

# NEARBY RESTAURANTS

- JEROME BETTIS GRILLE**  
Lounge & Bar/Grill  
393 N. Shore Drive | 412-224-6287
- HYDE PARK**  
Steak & Seafood  
247 N. Shore Drive | 412-222-4014
- MCFADDEN'S**  
221N. Shore Drive | 412-224-6287
- ATRIA'S AT PNC PARK**  
American/Continental  
103 Federal Street | 412-322-1850
- SIX PENN KITCHEN**  
American/Continental  
46 6th Street | 412-566-7366
- INDIA PALACE**  
International  
137 6th Street | 412-471-0660
- RED BEARD'S**  
Lounge & Bar/Grill  
144 6th Street | 412-261-2324
- OLIVE OR TWIST**  
Lounge & Bar/Grill  
140 6th Street | 412-255-0525
- PETER ALLEN'S**  
International  
613 Penn Avenue | 412-642-6677
- MEAT AND POTATOES**  
American/Continental  
649 Penn Avenue | 412-325-7007
- PROPER BRICK OVEN**  
International  
139 7th Street | 412-281-5700
- NICKY'S THAI KITCHEN**  
International  
903 Penn Avenue | 412-471-8424
- SONOMA GRILL**  
American/Continental  
947 Penn Avenue | 412-697-1336
- ELEVEN**  
American/Continental  
1150 Smallman Street | 412-201-5656
- LIDIA'S**  
International  
1400 Smallman Street | 412-552-0150
- KAYA**  
International  
2000 Smallman Street | 412-261-6565
- PAMELA'S**  
Breakfast  
60 21st Street | 412-281-6366
- DELUCA'S**  
Breakfast  
2015 Penn Avenue | 412-566-2195
- EDDIE MERLOT'S**  
Steak & Seafood  
444 Liberty Avenue | 412-235-7676
- LAS VELAS**  
International  
21 Market Square | 412-251-0031
- DIAMOND MARKET GRILL**  
Lounge & Bar/Grill  
430 Market Street | 412-325-2000
- NOLA**  
International  
24 Market Square | 412-471-9100
- PERLE**  
Lounge & Bar/Grill  
25 Market Square | 412-471-2058
- WINGHARTS**  
Lounge & Bar/Grill  
5 Market Square | 412-434-5600
- PRIMANTI BROTHERS**  
Lounge & Bar/Grill  
2 Market Square | 412-261-1599
- POROS GREEK**  
International  
2 PPG Plaza | 412-904-2051
- SIENNA ON THE SQUARE**  
International  
22 Market Square | 412-281-6363
- PIZZAIOLO PRIMO**  
International  
8 Market Square | 412-575-5858
- HABITAT**  
American/Continental  
510 Market Square | 412-773-8848
- PORK & BEANS**  
Barbecue  
136 6th Street | 412-338-1876
- TAKO**  
International  
214 6th Street | 412-471-8256
- BUTCHER AND THE RYE**  
American/Continental  
212 6th Street | 412-391-2752
- MORTON'S**  
Steak & Seafood  
625 Liberty Avenue | 412-261-7141
- SOCIAL HOUSE 7**  
American/Continental  
900 Penn Avenue | 412-338-6463
- NINE ON NINE**  
American/Continental  
900 Penn Avenue | 412-338-6463
- SHARP EDGE**  
Lounge & Bar/Grill  
922 Penn Avenue | 412-338-2437
- SEVICHE**  
International  
930 Penn Avenue | 412-967-3120
- AUGUST HENRY'S SALOON**  
Lounge & Bar/Grill  
946 Penn Avenue | 412-765-3270
- BAKERSFIELD**  
International  
940 Penn Avenue | 412-586-5024
- SIENNA MERCADO**  
International  
942 Penn Avenue | 412-281-2810
- TEN PENNY**  
Lounge & Bar/Grill  
960 Penn Avenue | 412-318-8000
- RUTH'S CHRIS**  
Steak & Seafood  
6 PPG Place | 412-391-4800
- VALLOZZI**  
International  
220 Fifth Avenue | 412-394-3400
- CAPITAL GRILLE**  
Steak & Seafood  
301 Fifth Avenue | 412-338-9100
- MCCORMICK & SCHMICK'S**  
Steak & Seafood  
301 Fifth Avenue | 412-201-6992
- TEXAS DE BRAZIL**  
Steak & Seafood  
240 W. Station Sq Drive  
412-230-4004
- KIKU JAPANESE**  
International  
225 W. Station Sq Drive  
412-765-3200
- HARD ROCK CAFÉ**  
Lounge & Bar/Grill  
230 W. Station Sq Drive  
412-481-7625
- THE GRAND CONCOURSE**  
Steak & Seafood  
100 W. Station Sq Drive  
412-261-1717
- BLUEBIRD KITCHEN**  
Breakfast  
221 Forbes Avenue | 412-642-4414
- THE COMMONER**  
American/Continental  
458 Strawberry Way | 412-230-4800
- UNION STANDARD**  
American/Continental  
325 William Penn Pl
- COMING SOON**  
American/Continental  
325 William Penn Pl
- COMING SOON**  
American/Continental  
600 Grant Street
- THE CARLTON**  
Steak & Seafood  
500 Grant Street (BNY Mellon Center)  
412-391-4152
- CHINATOWN INN**  
International  
520 Third Avenue | 412-261-1292

OMNI  HOTELS & RESORTS  
william penn | pittsburgh

MARK YOUR CALENDAR



**6th World Congress of Environmental and Resource Economists  
Gothenburg, Sweden  
June 25th-29th, 2018**

Every four years the World Congress of Environmental and Resource Economists is jointly organized by AERE, the European Association of Environmental and Resource Economists (EAERE), and the East Asian Association of Environmental and Resource Economists (EAAERE).

The Association of Environmental and Resource Economists (AERE), the East Asian Association of Environmental and Resource Economics (EAAERE), and the European Association of Environmental and Resource Economists (EAERE), announce that the 6th World Congress of Environmental and Resource Economists will be held in Gothenburg, Sweden, from June 25th to June 29th, 2018. The Congress will be organized by the University of Gothenburg, with Prof. Thomas Sterner chairing the Local Organizing Committee.





USDA's Economic Research Service conducts high-quality, objective research that includes the economic, environmental, and distributional implications of conservation policies and programs. ERS also investigates the environmental impact of broader agricultural policies and programs on land use, input use, and conservation practice adoption. ERS shapes its research program and products to inform and enhance public and private decision making. You can find ERS research online, in peer-reviewed journals and through *Amber Waves*, a monthly online magazine.

Recent research and analysis on conservation and the environment includes:

- ***Climate Change, Water Scarcity, and Adaptation in the U.S. Fieldcrop Sector***
- ***Additionality in U.S. Agricultural Conservation and Regulatory Offset Programs***
- ***Farm Profits and Adoption of Precision Agriculture***
- ***International Trade and Deforestation: Potential Policy Effects via a Global Economic Model***

See the full reports, webpages, or articles in *Amber Waves* magazine.

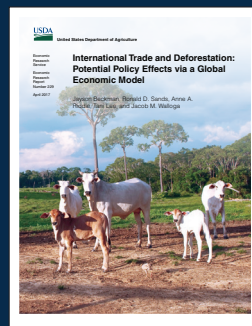
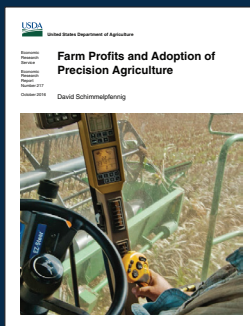
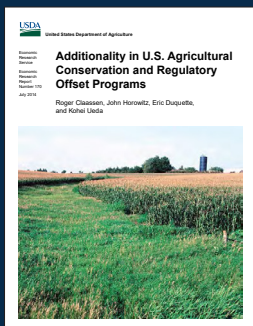
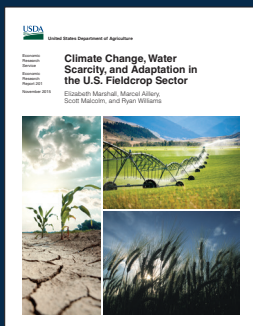



# An Oil Spill is No Day at the Beach.

**When oil spills foul our coasts, wildlife is not the only thing that suffers.**

The public can lose access to beaches, fishing, boating, and other recreational activities. Working with our partners, our office responds to these spills; measures the impacts to wildlife, habitats, and humans; and helps ensure that those responsible provide restoration to compensate for what was lost.

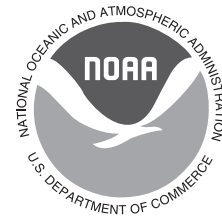

**[response.restoration.noaa.gov](https://response.restoration.noaa.gov)  
[darrp.noaa.gov](https://darrp.noaa.gov)**

National Oceanic and Atmospheric Administration | Office of Response and Restoration





## THE POWER OF **ECONOMICS**

---

**The Brattle Group** provides consulting and expert testimony in economics, finance, and regulation to law firms, corporations, and governments around the world.

We offer clients a comprehensive approach to the analysis of **environmental and natural resource litigation and regulation.**

Our team's expertise in environmental economics is complemented by the firm's broader spectrum of knowledge in energy, finance, and regulatory consulting, allowing us to serve a full range of client needs. We also work with leading academics and industry practitioners.

▶ Learn more at **[brattle.com](https://brattle.com)**.

THE **Brattle** GROUP



# CARD

Center for Agricultural and Rural Development

A source of  
objective,  
rigorous  
economic  
analysis for  
informed  
decision  
making

**I**nnovative  
agricultural  
policy  
research  
in four  
key areas

Agricultural Sectors

The Environment

Rural Development

Food & Nutrition



IOWA STATE UNIVERSITY  
OF SCIENCE AND TECHNOLOGY

**3 times a year**

CARD publishes their newsletter

the **Agricultural Policy Review**

**don't miss an issue!**

**sign up to receive the email alert!**



[www.card.iastate.edu](http://www.card.iastate.edu)



*A simple formula for the social cost of carbon,*  
winner of the 2016 best paper award of the Journal of Environmental Economics and Management.

**READ THE PAPER FOR FREE FOR A LIMITED TIME!**



“The JEEM editorial process deserves part of the credit in this case for sure. Even before the prize, we were glad that we submitted to JEEM, given the careful handling of the paper.” *Matti Liski*



“The paper took us quite an effort, and it is beautiful to see the result so much appreciated.” *Reyer Gerlagh*



“I hope to be publishing in JEEM again in the future”  
*Inge van den Bijgaart*



# Carnegie Mellon University Scott Institute for Energy Innovation

The Wilton E. Scott Institute for Energy Innovation  
welcomes the world's leading environmental and  
natural resource economists to Pittsburgh!

welcozzz

Special thanks to Carnegie Mellon Heinz College Professors of Economics and Public Policy **Karen Clay** (Co-Chair) and **Edson Severini** for their hard work in co-organizing the 2017 AERE Summer Conference!



We are honored to publish the  
**JOURNAL of the  
ASSOCIATION of  
ENVIRONMENTAL  
and RESOURCE  
ECONOMISTS**

AERE members receive *JAERE*  
as a benefit of membership.

As the official research journal of the Association of Environmental and Resource Economists, *JAERE* publishes papers that are devoted to environmental and natural resource issues. The journal's principal mission is to provide a forum for the scholarly exchange of ideas in the intersection of human behavior and the natural environment. *JAERE* presents a range of articles that are relevant for public policy, using approaches that are theoretical, empirical, or both. Learn more at [journals.uchicago.edu/jaere](http://journals.uchicago.edu/jaere).

### MARINE RESOURCE ECONOMICS

SAVE 20% WITH CODE "AER20" | RATES START AT ~~\$50.00~~ \$40.00 | [JOURNALS.UCHICAGO.EDU/MRE](http://JOURNALS.UCHICAGO.EDU/MRE)

*Marine Resource Economics* publishes creative and scholarly economic analyses of a range of issues related to natural resource use in the global marine environment. The scope of the journal includes conceptual and empirical investigations aimed at addressing real-world ocean and coastal policy problems.

*Taxes & shipping may apply. Offer expires 10/31/17, and excludes student subscriptions.*

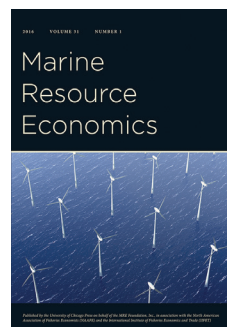

**THE UNIVERSITY OF CHICAGO PRESS JOURNALS**

# INNOVATIVE ECONOMICS JOURNALS from the UNIVERSITY of CHICAGO PRESS



**ECONOMIC DEVELOPMENT AND CULTURAL CHANGE**

**ECONOMIC DEVELOPMENT and CULTURAL CHANGE**

SAVE 20% WITH CODE "AER20"  
RATES START AT ~~\$68.00~~ \$54.40  
journals.uchicago.edu/edcc



**Innovation Policy and the Economy**

**INNOVATION POLICY and the ECONOMY**

SAVE 20% WITH CODE "AER20"  
RATES START AT ~~\$30.00~~ \$24.00  
journals.uchicago.edu/ipe



**Journal of HUMAN CAPITAL**

**JOURNAL of HUMAN CAPITAL**

SAVE 20% WITH CODE "AER20"  
RATES START AT ~~\$55.00~~ \$44.00  
journals.uchicago.edu/jhc



**JOURNAL of LABOR ECONOMICS**

**JOURNAL of LABOR ECONOMICS**

SAVE 20% WITH CODE "AER20"  
RATES START AT ~~\$82.00~~ \$65.60  
journals.uchicago.edu/jole



**The Journal of LAW & ECONOMICS**

**The JOURNAL of LAW and ECONOMICS**

SAVE 20% WITH CODE "AER20"  
RATES START AT ~~\$33.00~~ \$26.40  
journals.uchicago.edu/jle



**Journal of Political Economy**

**JOURNAL of POLITICAL ECONOMY**

SAVE 20% WITH CODE "AER20"  
RATES START AT ~~\$66.00~~ \$52.80  
journals.uchicago.edu/jpe



**NBER MACROECONOMICS ANNUAL**

**NBER MACROECONOMICS ANNUAL**

SAVE 20% WITH CODE "AER20"  
RATES START AT ~~\$45.00~~ \$36.00  
journals.uchicago.edu/ma



**Supreme Court Economic Review**

**SUPREME COURT ECONOMIC REVIEW**

SAVE 20% WITH CODE "AER20"  
RATES START AT ~~\$41.00~~ \$32.80  
journals.uchicago.edu/scer



**Tax Policy and the ECONOMY**

**TAX POLICY and the ECONOMY**

SAVE 20% WITH CODE "AER20"  
RATES START AT ~~\$30.00~~ \$24.00  
journals.uchicago.edu/tpc



## THE UNIVERSITY OF CHICAGO PRESS JOURNALS

Subscribe at [journals.uchicago.edu](http://journals.uchicago.edu), or by calling (877) 705-1878 (US & Canada) or (773) 753-3347 (intl). Taxes & shipping may apply. Offers expire 10/31/17, and exclude student subscriptions.